

CLEAN your touchscreen with **the cleaning cloth** before assembling case.

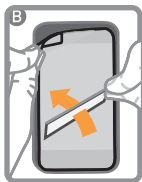

HOW TO APPLY the screen protector

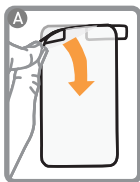

- A** Peel back tab ①; flip so that tab ② is face up.
- B** Lay film onto clean touchscreen, smooth out air bubbles with the edge of a credit card or bank card.
- C** Gently peel tab ② down and away, leaving film in place.

